

PROPERTY OVERVIEW

# GRAYS ROAD INDUSTRIAL CENTER

2301 GRAYS ROAD, BALTIMORE, MD 21222



## Building Information

- Quick access from I-695 and North Point Boulevard
- Located in the Chesapeake Enterprise Zone
- One industrial-warehouse building totalling 119,345 SF
- Single-story metal construction
- 23 acres of exterior land storage
- 12' to 20' clear ceiling heights
- Docks and drive-ins
- 120/208 volt, 3-phase, 4-wire service
- 10-ton crane
- Public utilities
- Four miles to marine terminal
- Baltimore County, MH-IM zoning: heavy manufacturing, warehouse/distribution, office, trucking, terminal



## Surrounding Amenities

- Denny's
- IHOP
- Key Brewing Co.
- McDonald's
- Taco Bell
- Texas Roadhouse
- The Sea Horse Inn
- The Seasoned Mariner
- Tiki Lee's





# Site Plan

Grays Road Industrial Center

2301 Grays Road

119,485 SF

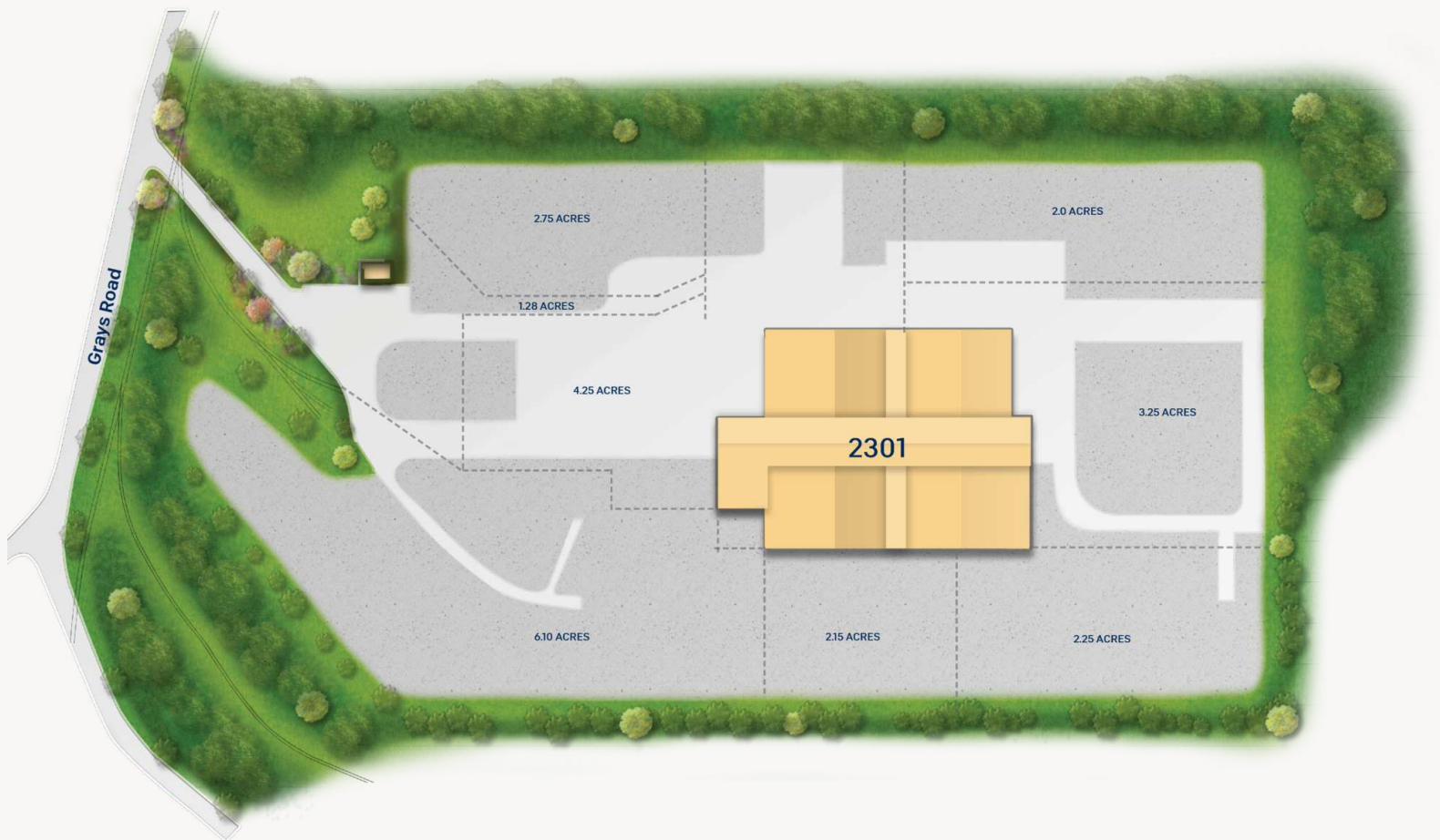

*“When we first came to the Maryland market, Merritt provided our CEO - on a handshake - a building for lease when no one else thought that we were worth it. We like the Merritt company, because they are people of their word.”*

**LYNDA BAKER**  
SENIOR PROJECT MANAGEMENT SPECIALIST  
FEDEX EXPRESS





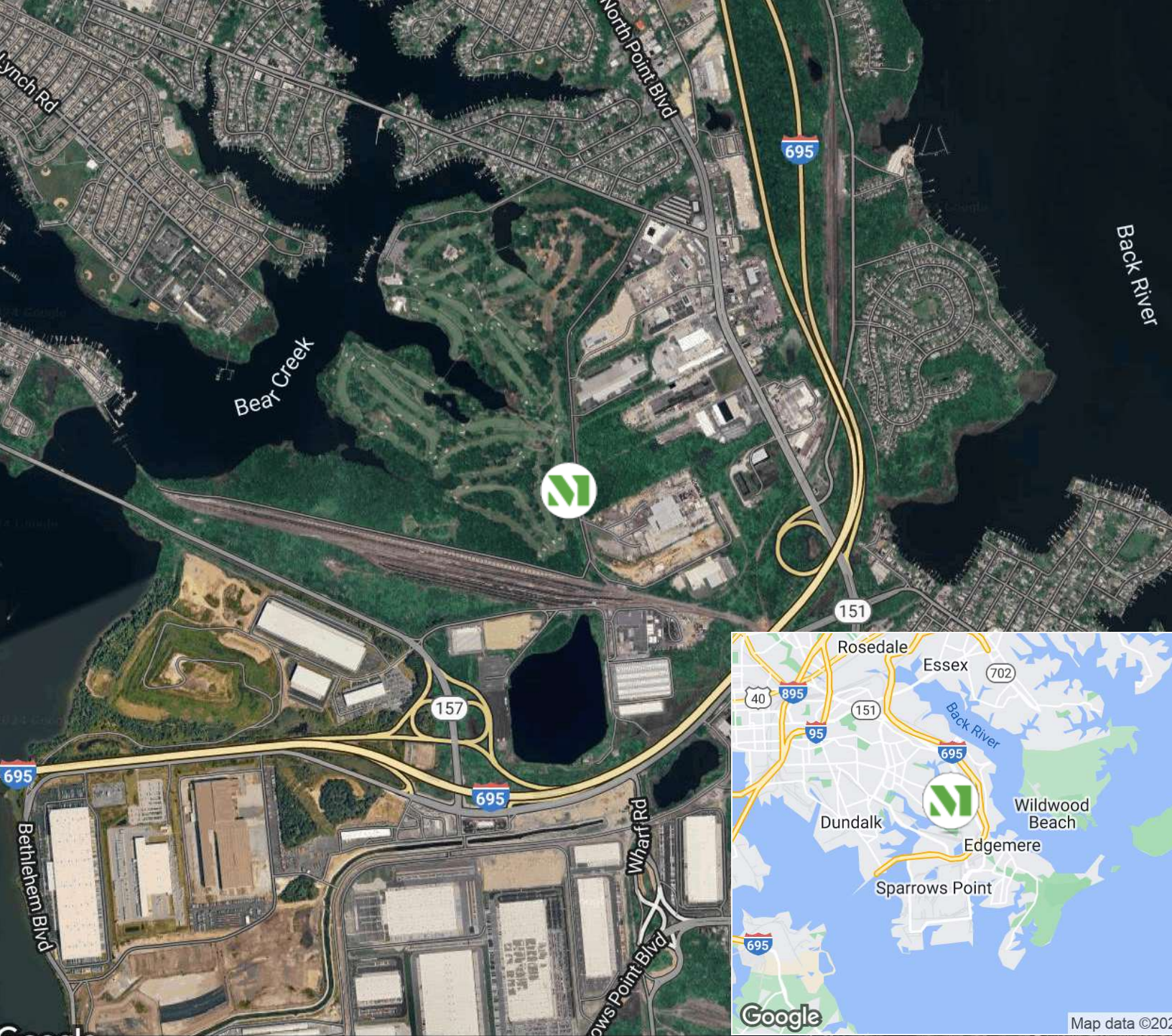

## CREATING HOMES FOR BUSINESSES

Established in 1967, Merritt Properties is a privately held commercial real estate company offering over 21 million square feet of Class A office, flex, warehouse, industrial, retail and build-to-suit spaces throughout Maryland, Florida, North Carolina and Virginia. We design, build, lease and manage our properties for the long term with a commitment to providing the highest quality service to all of our customers.

**For additional information or to schedule a tour, contact:**

Whit Levering | Ashley Reimer | Lauren Lindsay

**[merrittproperties.com](http://merrittproperties.com)**

MD: 410.298.2600 | VA: 703.858.2725 | NC: 919.526.0070 | FL: 904.515.2030

